

FLOORPLAN

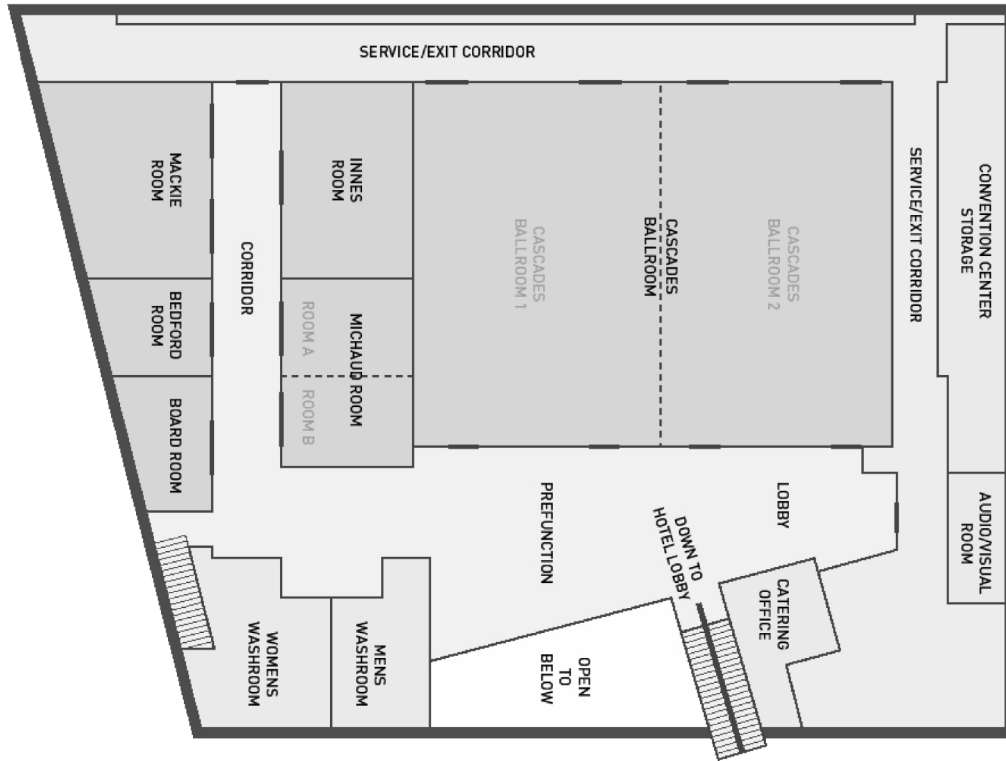

ROOM CAPACITIES CHART

Room	Total Sq Ft	Ceiling Ht	Class	Thtr	Ovl 10	Reception	Boardroom	U Shape	Hollow Square
Cascades Ballroom	7,721	18'	300	650	500	700	-	-	-
Ballroom (1/2)	3,860	18'	150	300	220	300	-	-	-
Mackie Room	1,243	10'	60	110	80	120	40	40	45
Innes Room	1,084	10'	40	90	50	80	40	30	40
Michaud Room	1,008	10'	35	90	50	80	40	30	40
Michaud (A/B)	505	10'	18	40	30	40	20	15	20
Bedford Room	447	10'	18	35	30	30	20	16	20
Executive Boardroom	428	10'	-	-	-	-	14	-	-